

Further research *other documented yard area use*

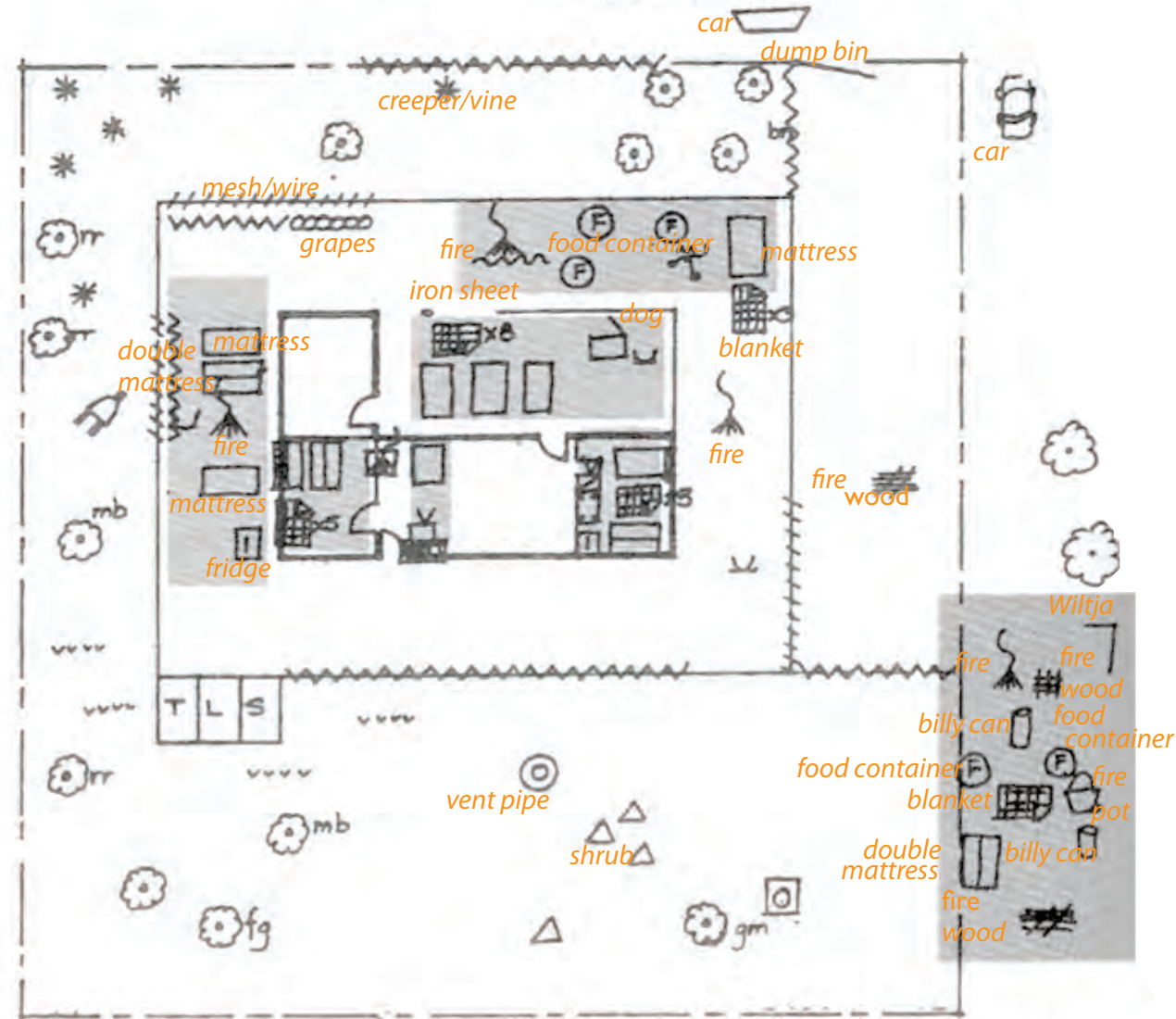

Images from: *Housing for Health, Towards a Healthier Living Environment for Aboriginal Australia*, 1994

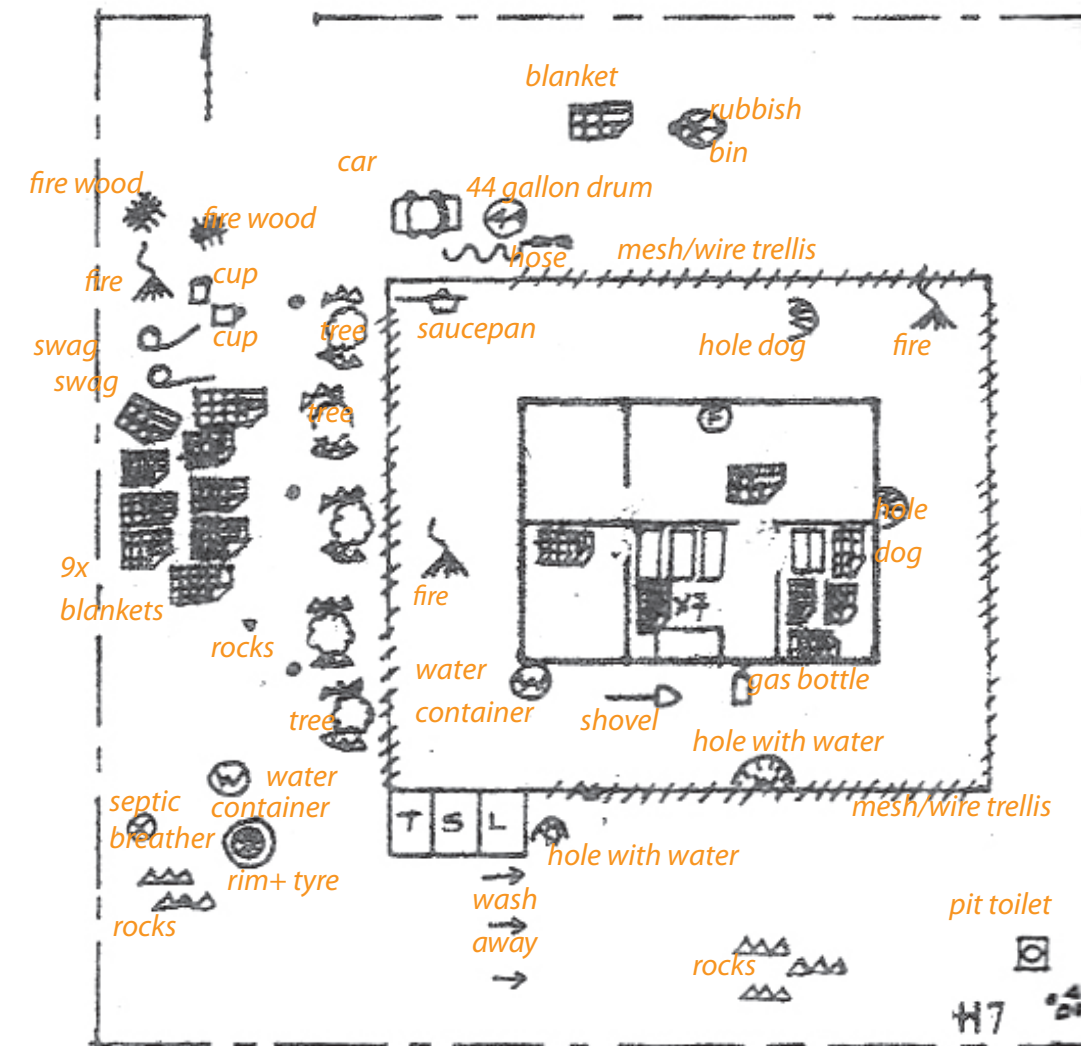

annotations by designer

Field research *no taps, no power points, no elevated shelves... no services infrastuctre*



veranda living



veranda living



yard cooking



yard cooking



yard living

The Initial Concept

Yardmaster UB250

Part of a new range of yard infrastructure furniture
... going the extra yard

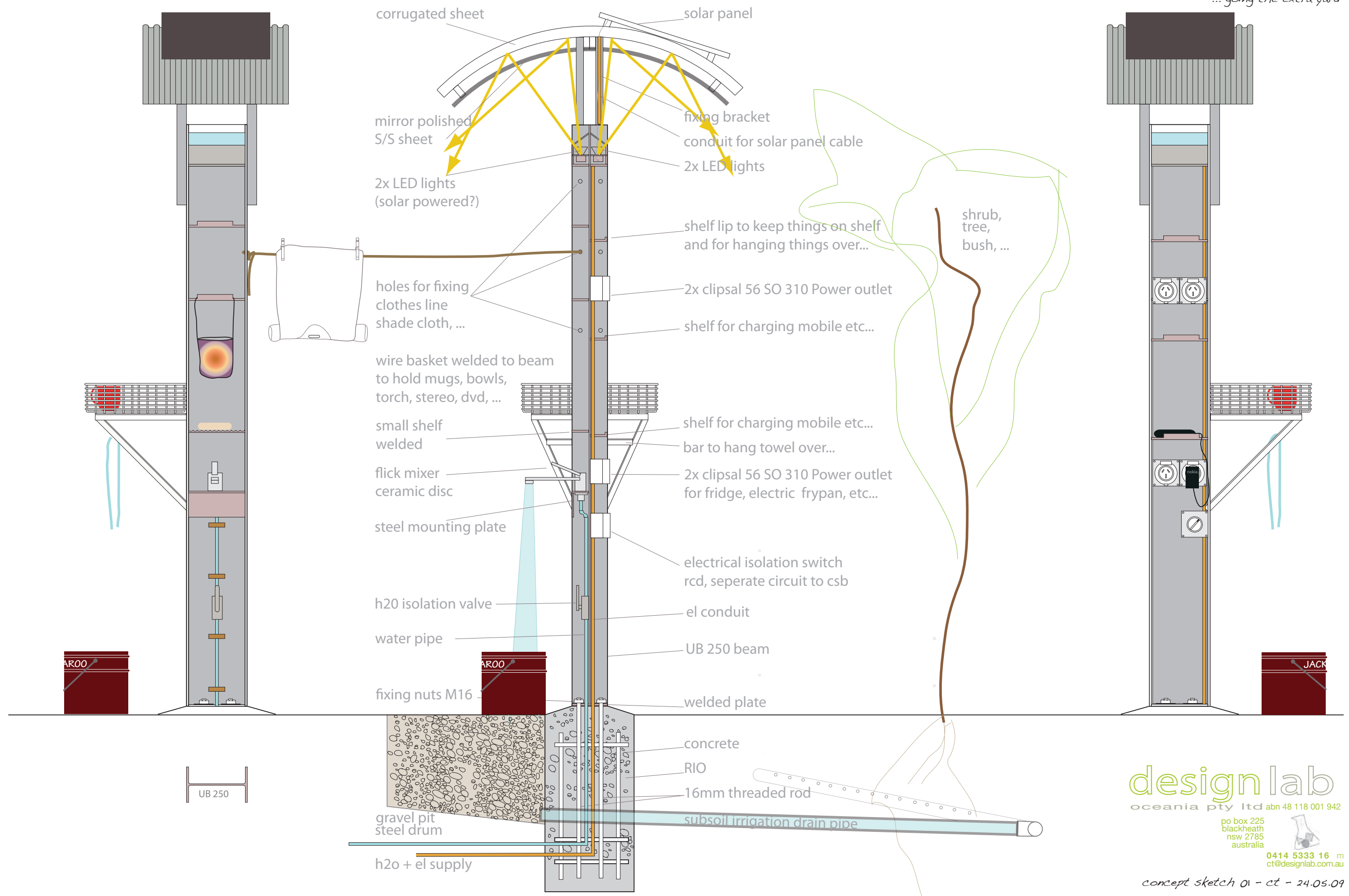

designlab
oceania pty ltd abn 48 118 001 942
po box 225
blackheath
nsw 2785
australia



0414 5333 16 m
ct@designlab.com.au

concept sketch 01 - ct - 24.05.09

proposed yard plans



HOUSE 1 2 & 3	
YM 1	<ul style="list-style-type: none">• Power• Spot/Flood light• High LED light• Sulo bin• Moulded cupboard
YM 2	<ul style="list-style-type: none">• Power• Spot/Flood light• High LED light• Water (flick mixer, tap guard, plumbing guard, sump drain)• Jumbo sink• Bench top
YM 3	<ul style="list-style-type: none">• Power• High LED light• Basket• inc washing line
YM 4	<ul style="list-style-type: none">• Water (flick mixer, tap guard, plumbing guard, sump drain)
YM 5	<ul style="list-style-type: none">• Washing line
<ul style="list-style-type: none">Planter boxOutdoor storageHigh level shelvingSpot / flood light	

proposed installation options



half height with basket

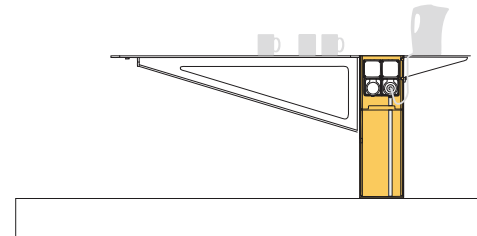

half height, 2x table,
power & tap

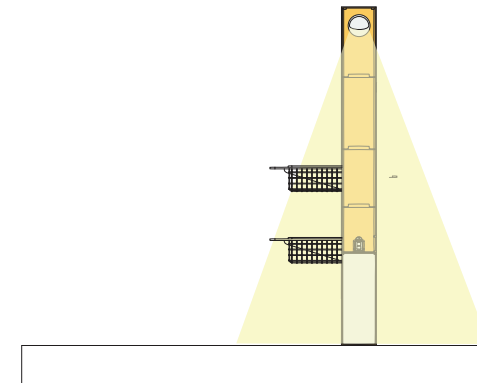

full height, stand alone
with 2x basket, lights
tap & power

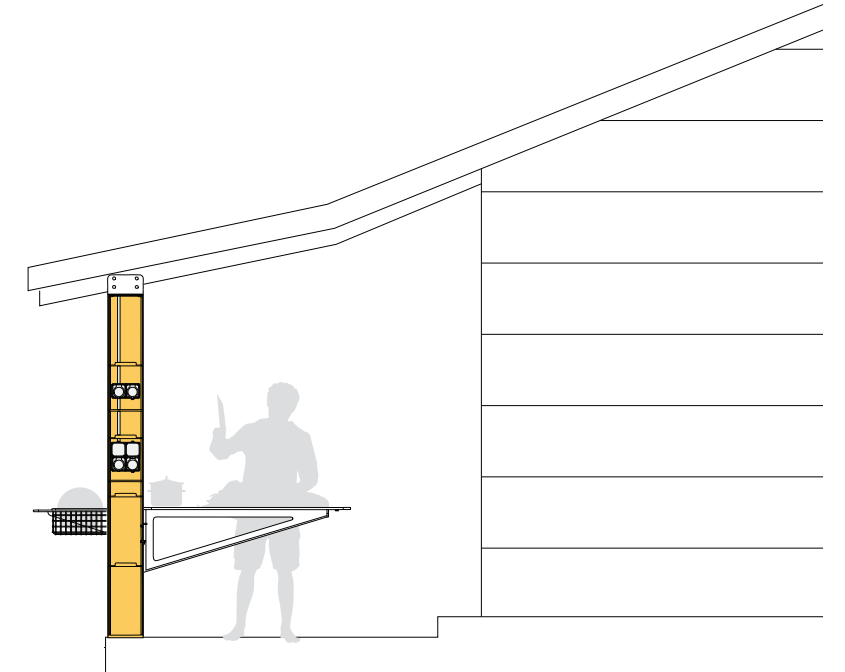

full height, integrated with basket,
lights, large table, power & tap

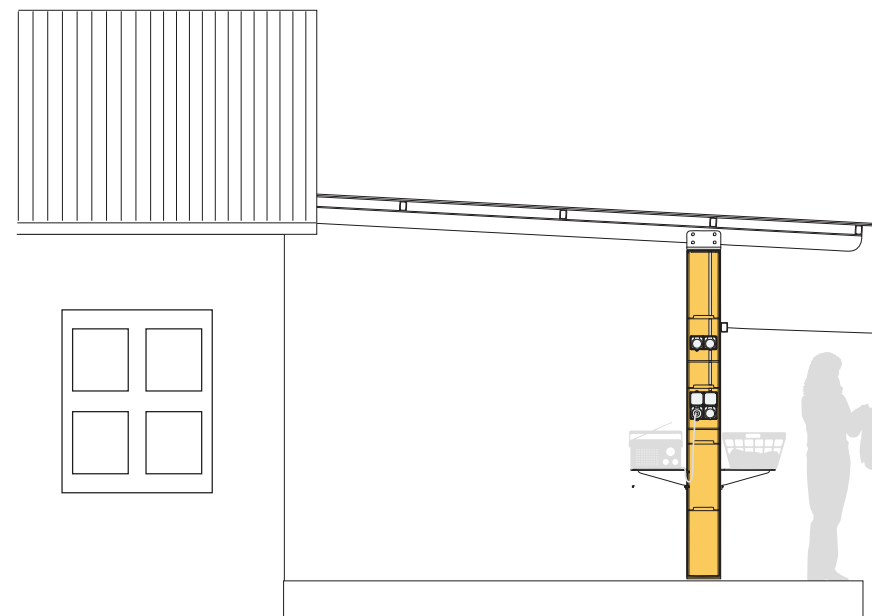

full height, integrated, 2x small tables,
lights, power

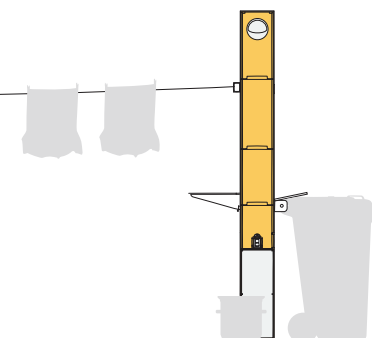

full height, stand alone
with Sulo bin holder, tap,
drain, power & small table

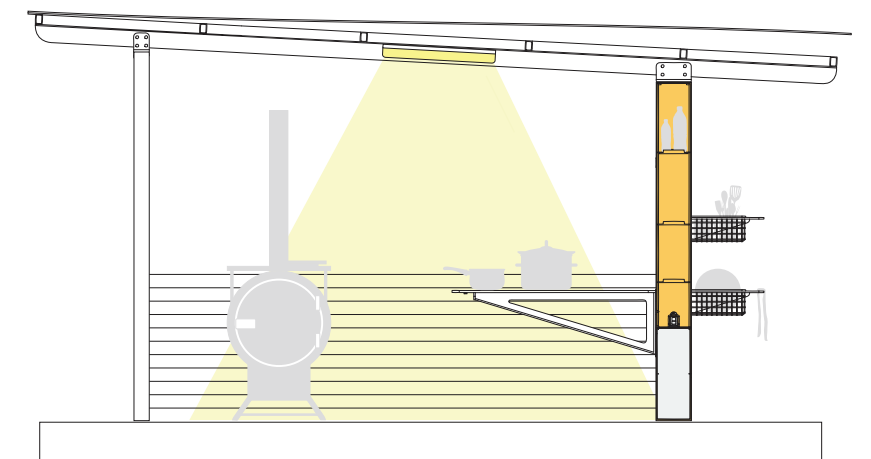

full height, integrated with basket,
lights, large table, power & tap

proposed installation options

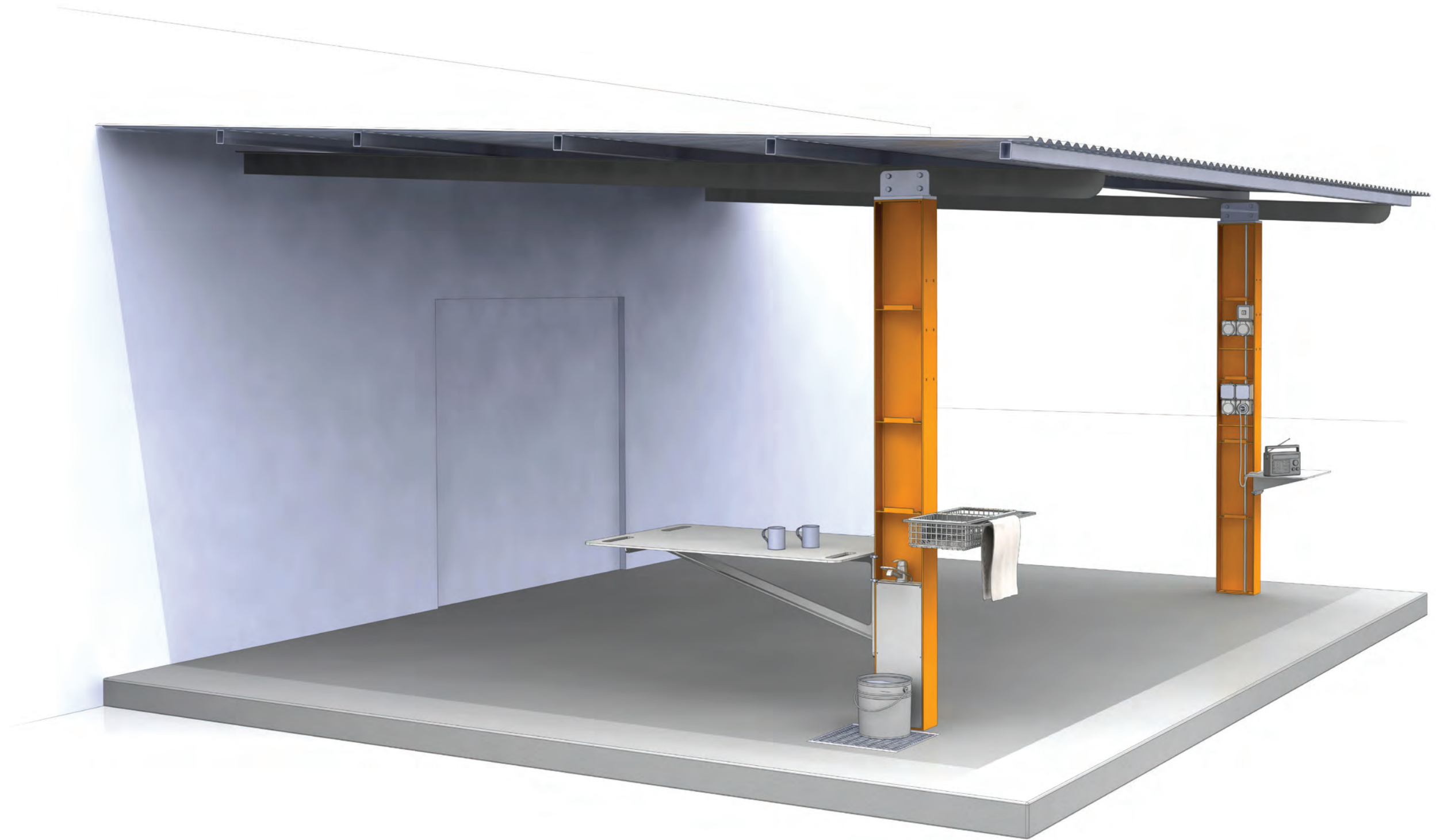
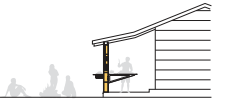

large table, basket, tap, drain grate, power & lights

accessories

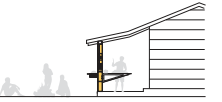

add water

Water access and drain:

- Ewing flick mixer
- Galvanised steel tap guard
- Impact resistant polycarbonate plumbing guard
- Sump drain with hinged grate



Mounting height:
670 or 900mm with sink

add power

- Clipsal (IP 56) power facilities include:
 - 1 x junction box containing 2 outlets
 - 1 x isolator switch
- Additional junction boxes available

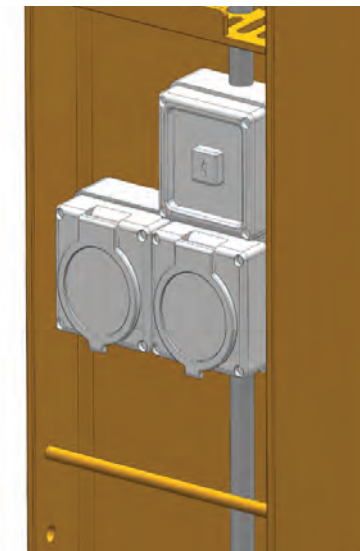

Mounting height:
1050 and / or 1700mm

add lighting

LED light boxes

- LED strips (IP 67) behind impact resistant
- Lexan translucent plumbing guard.

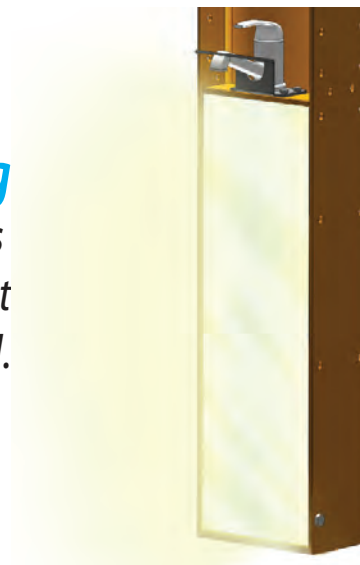

Mounting height:
under tap and / or
above top shelf

accessories



add storage

- Moulded cupboard** (600 x 600 x 370mm) features:
- Rubber gasket, protecting contents from heat, dust and insects
 - Magnetic closure
 - Strong mounting brackets

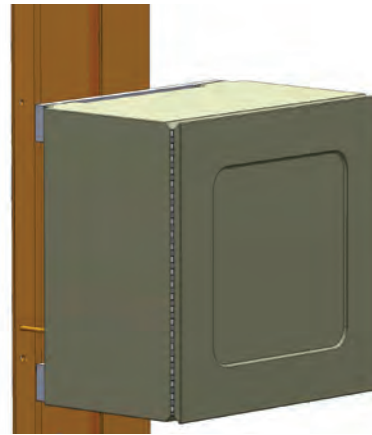

Mounting height:
1400mm (Bottom shelf)

add basket shelf

- Steel baskets providing storage for dishes, utensils etc.
 - includes integral towel rail
- 8mm hot dipped galvanised steel bracket
- 4mm stainless steel wire baskets (270 x 270 x 130mm each)



Mounting height:
1350mm

add table

- Providing surface for preparing food, resting laundry baskets etc.
 - 8mm hot dipped galvanised steel
 - 12mm recycled food grade PE table top
- 900 x 600mm table top



Mounting height:
900mm

accessories

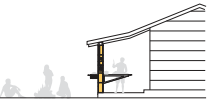

add laundry

- S/S Jumbo sink tub (474 x 404 x 202mm) for:
 - washing dishes
 - washing children
- Robust galvanised mounting bracket

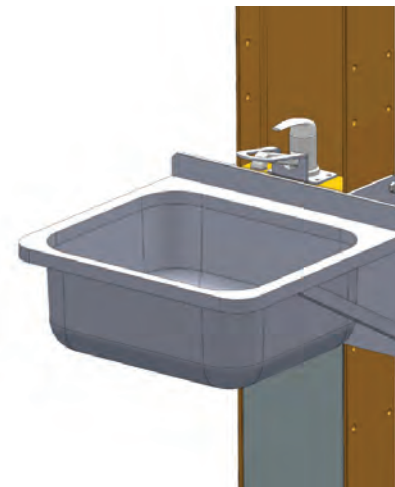

Mounting height:
900mm

add washing line

- Sturdy washing line capable of withstanding large spans
- 3mm high tensile Stainless Steel cable with integrated turn buckle
- Galvanised 'C' channel bracket (75 x 40 x 4mm)
- 10 x 8m lengths

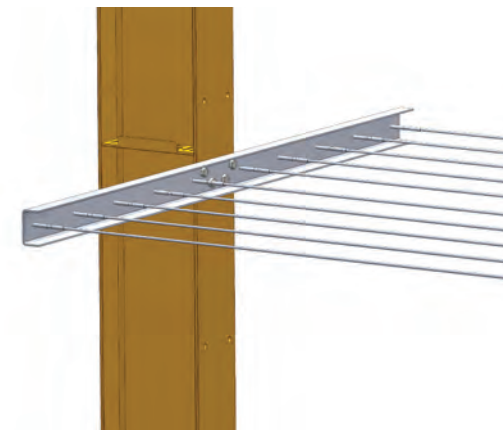

height:

add bin

- Sulo wheelie bin holder
- Galvanised bin holding bracket
- Can be locked



Mounting height:
920mm

add key safe

- Supra S6 key safe provides secure onsite key management in areas of high use or multiple users



Mounting height:
1080mm (bottom)

Prototype installation

site work



Contractors installing unit



Carport column with light, bin holder & housenumber



Washing line column, basket, lights



Contractors installing free standing unit



Washing line columns, basket, lights, power



Carport column with light, bin holder & housenumber