

The Nepal Village Health Improvement Program

Water supply and sanitation feasibility report
to improve the school living environment



Healthhabitat 2015

Toilet Sizes and Areas

School Name:

Date:

Include

Photos of existing toilet blocks, cubicles, school, grounds, distances

Any existing site plans available?

Facilities

How many existing toilets are there?:

How many Girls' toilets?:

How many Boys' toilets?:

How many Teachers' toilets?:

Condition Report

Tally results for all toilets:

[illegible]

Toilet Sizes and Areas

School Population

How many Boys are at the school?:

How many Girls are at the school?:

How many Teachers are at the school?:

Number of toilets and handwashing points

Circle appropriate field based on total number of people using the school's toilets

Number of people using facilities	Toilets required for school (1 toilet per 60 people)	Girls	Boys*	Teachers	Hand basins
100	3	1	1	1	2
200	3	1	1	1	2
300	5	2	2	1	2
400	7	3	3	1	4
500	8	3	3	2	4
600	10	4	4	2	4
700	12	5	5	2	6
800	14	6	6	2	6
900	15	6	6	3	8
1000	17	7	7	3	8
*1 of the male toilets will be a urinal, unless the total number of male toilets is less than 2					

Divisional breakdown of Boy vs Girl toilets depends on the ratio of Boys:Girls at the school

For example, in a school with 600 people and a ratio of Boys:Girls = 3:1 toilet allocation for students = 6:2 (Boys:Girls)

Areas

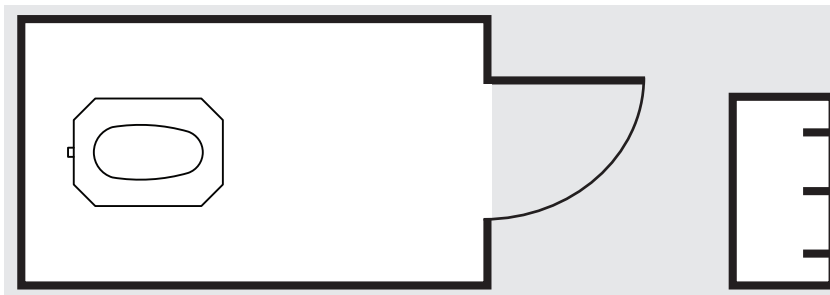

The average size of a toilet cubicle, including slab and handwashing points, is **5.2m²**

To calculate approximate area of new toilet blocks, multiply number of toilets - found above - by 5.2m²

For example, a school with 800 students will need 14 toilets. These will occupy an approximate area of 72.8m² including slab and handwashing points

Notes:

Water: In and Out

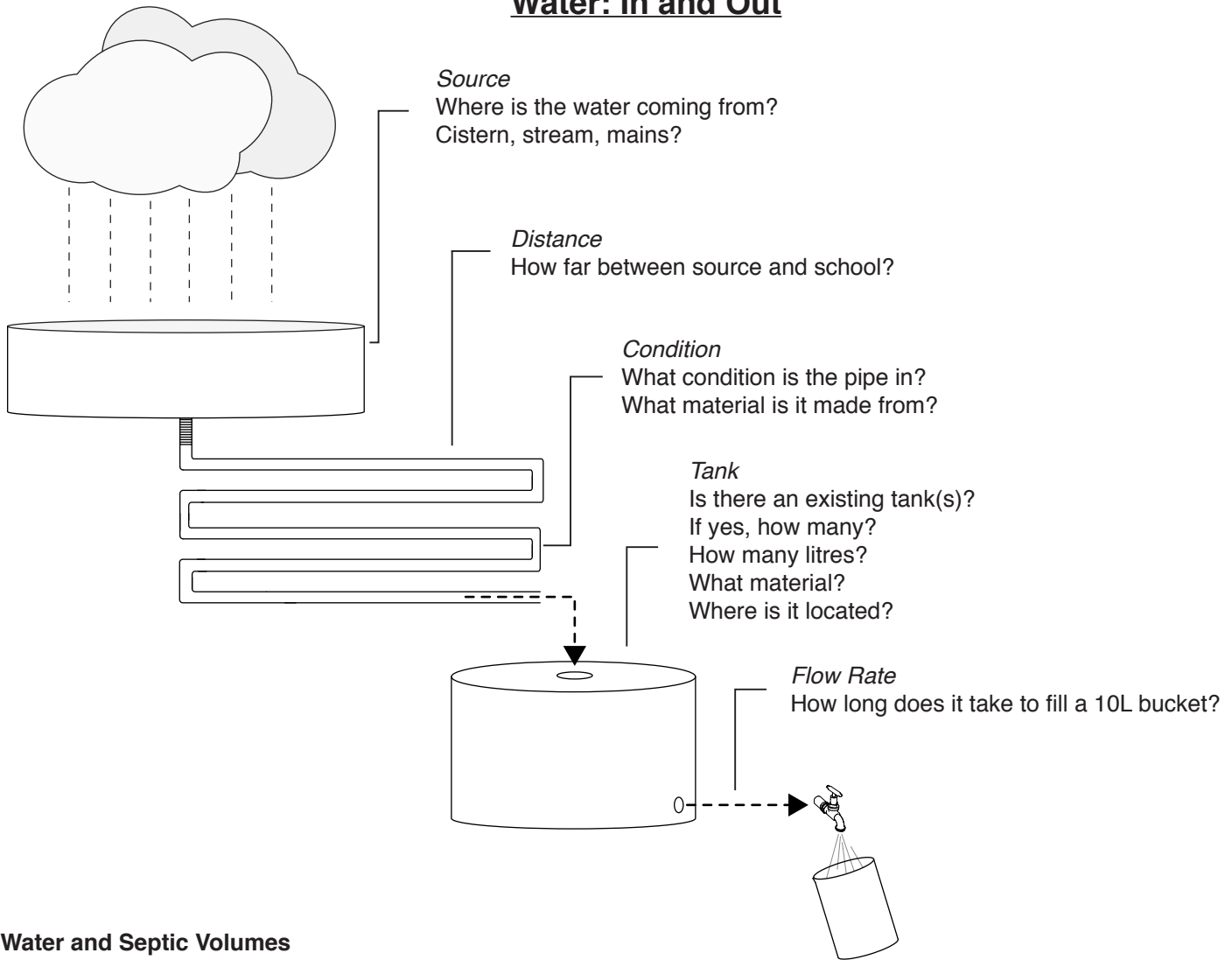

Water and Septic Volumes

Number of people using facilities *	Hand washing (1 litre per person)	Toilet dip flush (3 litre per person)	brushing @30% (2 litres per person) °	Total volume used (litres)	Septic tanks required	Septic tank footprint (m/ft) Tank always 5' wide	Soakage trench length (m/ft)
100	100	300	60	460	1	2.2*1.5 / 7'4"	2.3 / 7'8"
200	200	600	120	920	1	2.4*1.5 / 8'	4.6 / 15'4"
300	300	900	180	1380	2	1.3*1.5 / 4'4"	6.9 / 23'
400	400	1200	240	1840	2	1.4*1.5 / 4'8"	9.2 / 30'8"
500	500	1500	300	2300	2	1.6*1.5 / 5'4"	11.5 / 38'4"
600	600	1800	360	2760	2	1.7*1.5 / 5'8"	13.8 / 46'
700	700	2100	420	3220	2	1.8*1.5 / 6'	16.1 / 53'8"
800	800	2400	480	3680	2	1.9*1.5 / 6'4"	18.4 / 61'4"
900	900	2700	540	4140	2	2.0*1.5 / 6'8"	20.7 / 69'
1000	1000	3000	600	4600	2	2.1*1.5 / 7'	23 / 76'8"

* **Number of People** includes teachers and all students

° **Tooth brushing** data reflects taps running continuously for 3 minutes

Septic Tank Sizes

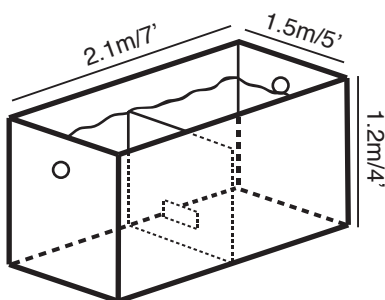

2200 Litres

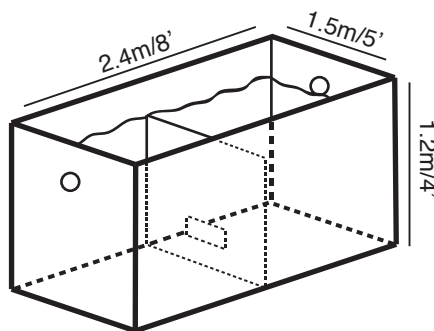

3300 Litres

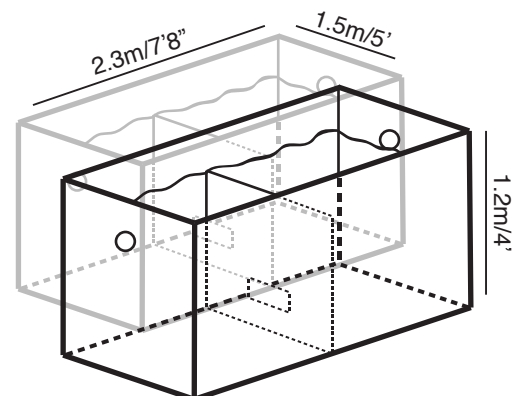

6300 Litres